

# Colour is our nature



## Connecting and configuring the LINEARdrive 100D/180D



A Removing the cover

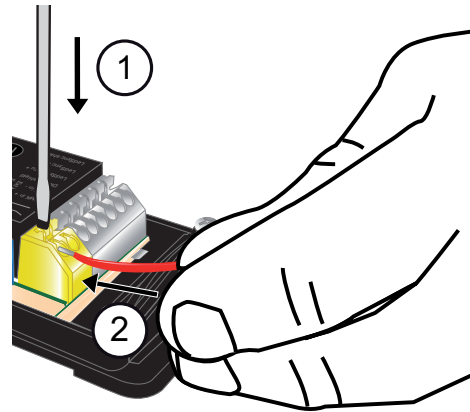

E Optional: Connecting external control device or network cabling



B Removing the strain reliefs



F Fastening the strain reliefs

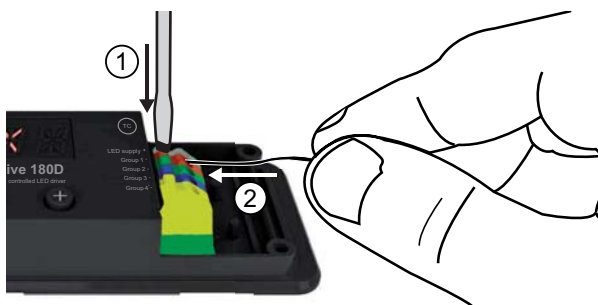

C Connecting LED wires

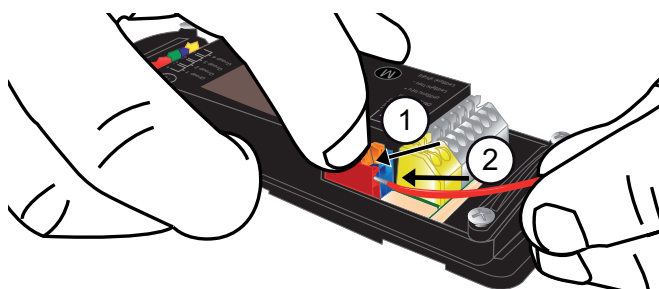

D Connecting power supply wires

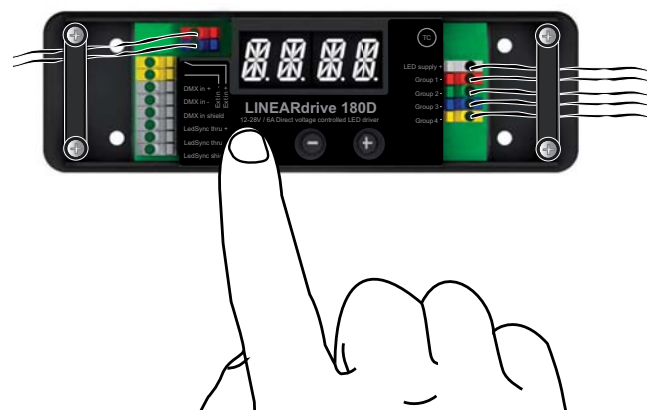

G Configuring the LINEARdrive DC

**Manual configuration**

**1. Select mode of operation:**

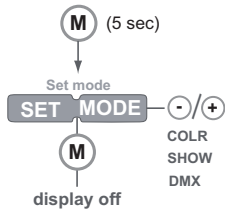

**2. Set LED groups:**

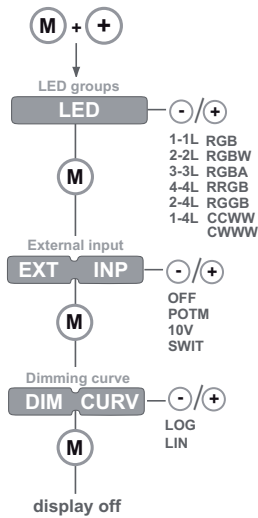

**3. Standalone operation - Colour\***

or

**Standalone operation - Show -**

or

**Networked operation - DMX -**

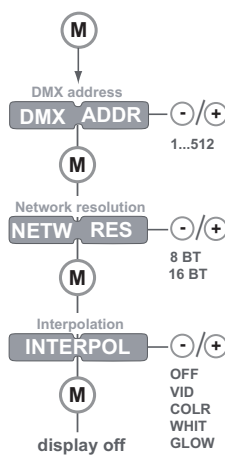
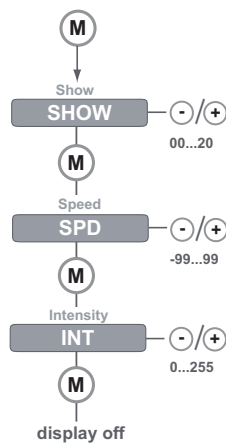
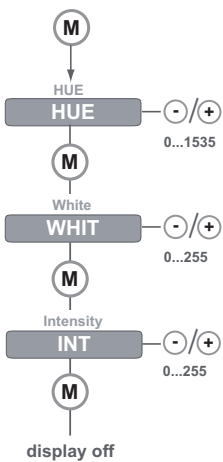

\* The colour menu depends on the LED group settings you have selected in step 2.

**Other features**

**Visual test run**

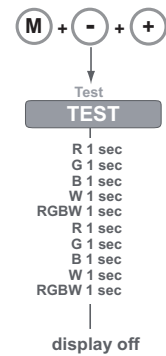

**Locking the configuration:**

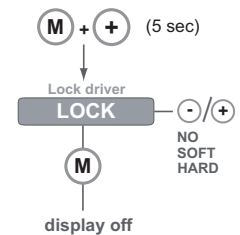

**Reset to factory defaults**

